



A-UNIQUE

ASIA UNIQUE LED LIGHTING CO., LTD

LED Linear Light

AU03-LL Series

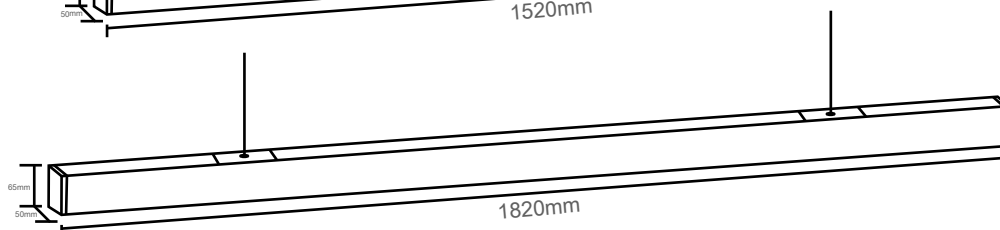
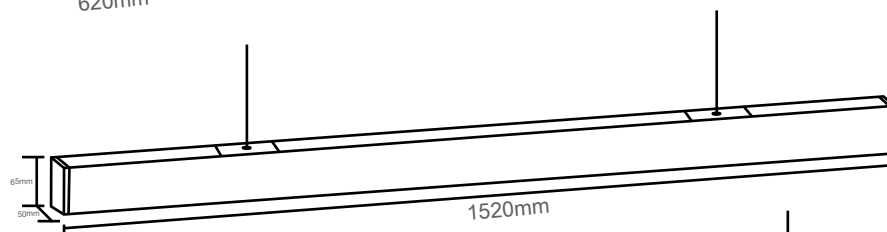
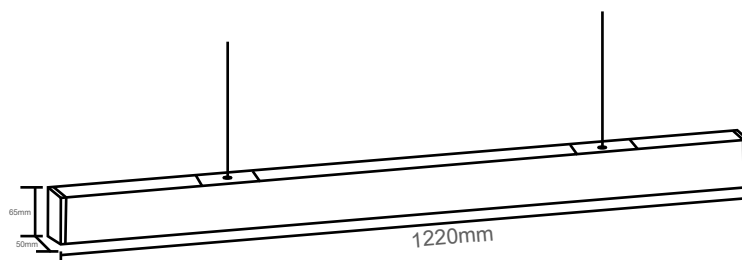
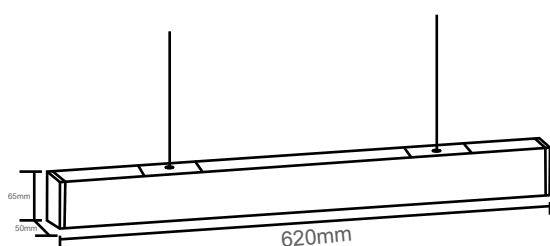
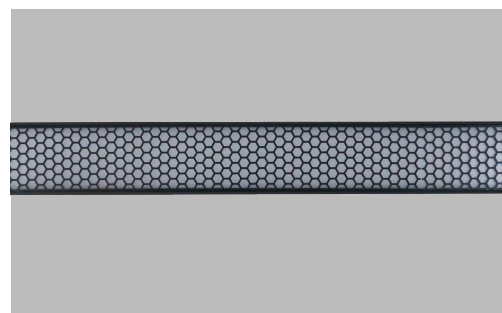
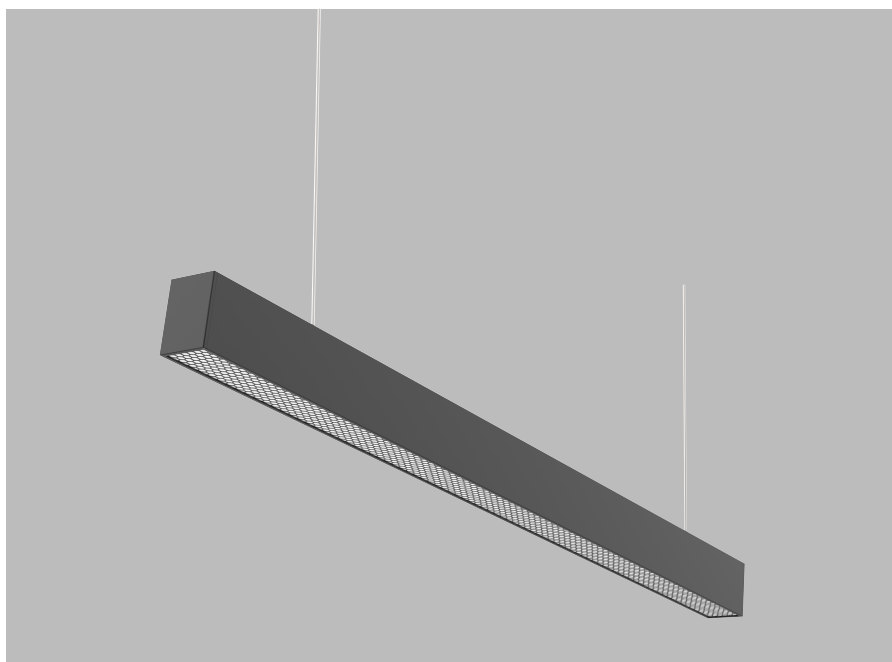

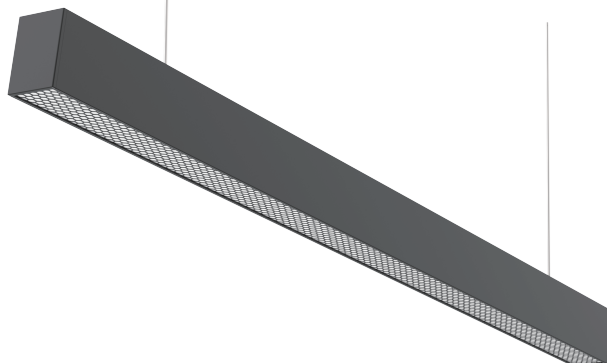

General Features:

- High-quality aluminum construction, excellent heat dissipation and superior texture quality
- Minimalistic and attractive design
- Single CCT or 3 CCT selectable optional
- Low glare design, UGR<19
- Can be suspended or surface mounted
- Triac dimming, 1-10V dimming or Dali Dimming available
- Linkable - Can be linked one to another, not just limited to a straight line, add connectors and you can create any pattern to suit the space.
- Perfect for applications like Conference and lecture halls, Shops, Libraries, Offices, Supermarket, Universities, and Factory

Technical Specifications

Model No.		AU03-LL6550-202F	AU03-LL6550-404F	AU03-LL6550-505F	AU03-LL6550-606F
Dimension(mm)		620*65*50	1220*65*50	1520*65*50	1820*65*50
Cutout(mm)		/	/	/	/
Wattage(w)		20W	40W	50W	60W
Input Voltage(v)		AC220~240V			
Light Source		SMD2835			
SDCM		<6			
CCT	Single CCT(K)	2700K/3000K/4000K/5000K/6500K			
	3 CCT(K)	3000K/ 4000K /6500K			
Luminous Flux (lm)	URG>19	1800lm~2000lm±5%	3600lm~4000lm±5%	4500lm~5000lm±5%	5400lm~6000lm±5%
	URG<19	600lm~800lm±5%	1200lm~1600lm±5%	1200lm~1600lm±5%	1800lm~2400lm±5%
CRI		>80Ra			
Beam Angle(°)	URG>19	90°			
	URG<19	60°			
Dimming option		Available			
Protection Class		Class I			
Degree of protection(IP)		IP20			
Impact Resistance(IK)		IK08			
Material		Aluminum + PC			
L70		54000hrs			
Operation Temp.(°C)		-20~ 45°C			
Installation		Surface Mounted & Suspension Mounted			
Certificates		CE, Rohs, SAA & C-tick			
Warranty		5 Years			

Packing information

Model Number	Weight/Luminaire (kg)	QTY/BOX (pcs)	Inner Box Size (mm)	Weight/Box (kg)	QTY/CTN (pcs)	Carton Size (cm)	Weight/CTN (kg)	QTY/20GP (PCS)	QTY/40GP (PCS)	QTY/40HQ (PCS)
AU03-LL6550-202F	1.9	1	635*85*55	1.8	8	622*22.5*17	7.9	7232	15152	17176
AU03-LL6550-404F	2.1	1	1235*85*55	1.8	6	122*22.5*17	11.3	3222	7332	8412
AU03-LL6550-505F	2.6	1	1535*85*55	2.35	6	152*22.5*17	15.0	2730	5928	6768
AU03-LL6550-606F	2.6	1	1835*85*55	2.35	6	152*22.5*17	15.0	2730	5928	6768

Installation Instructions

Surface

1. Turn off the main power switch.

2. Take out the light fitting and fix it on the ceiling.

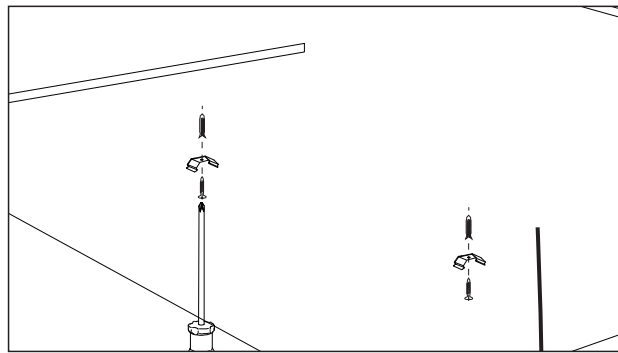
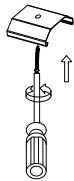

3. Surface Mount Installation

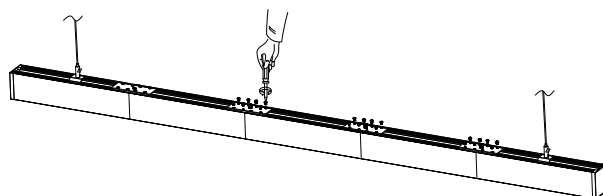
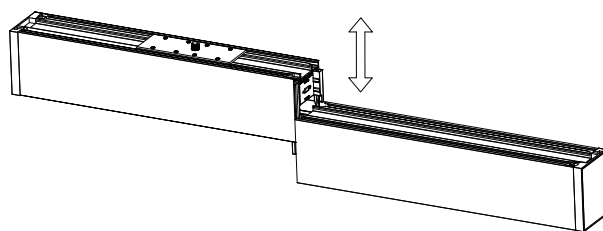
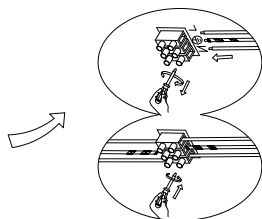
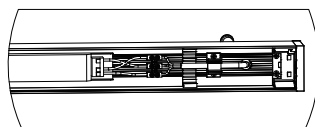
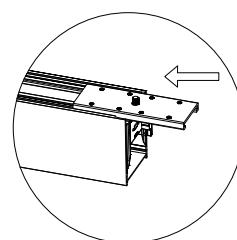
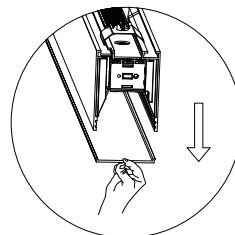
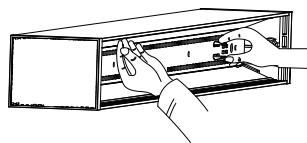
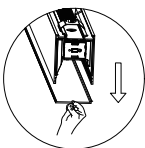
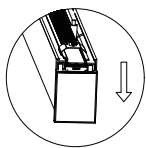
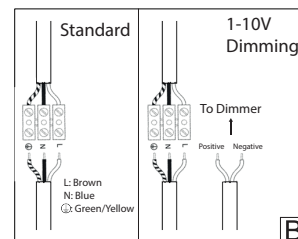
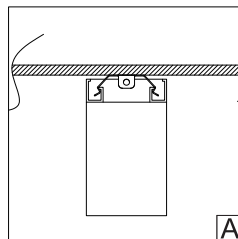
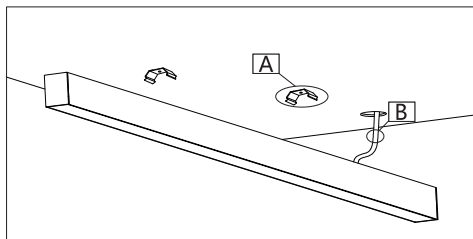

Please Note:

- * Turn off and isolate the electrical supply before connecting this fitting to the building wires.
- * Must be installed, or connected by licenced electrician.
- * The Luminaires are intended for indoor use only.

Applications :

- Hospitality applications
- Residential applications
- Office Buildings
- Hotels
- Shopping Malls
- Supermarkets

Installation Instructions

Suspension

1. Turn off the main power switch.

2. Take out the light fitting and fix it on the ceiling.

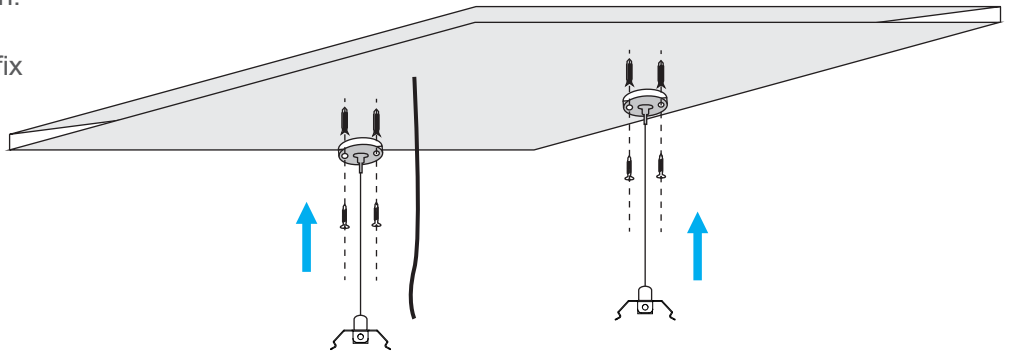
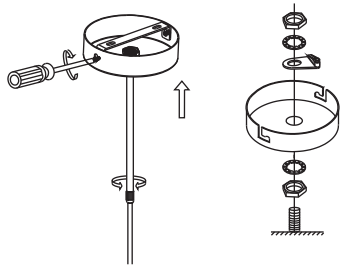

3. Suspension Mount Installation

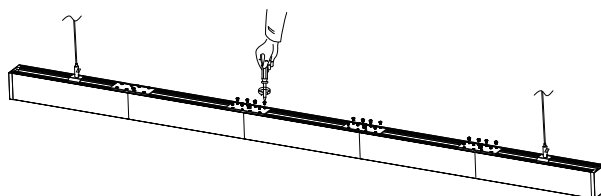
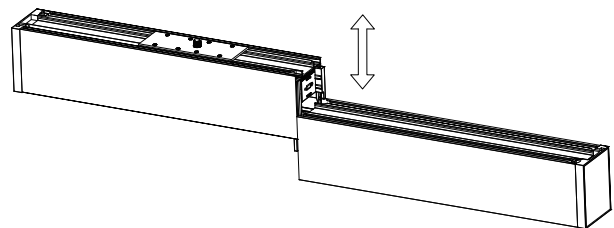
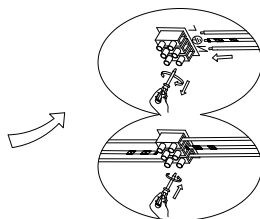
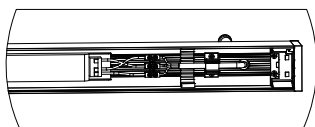
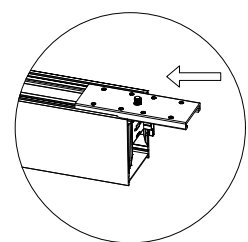
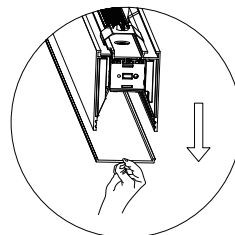
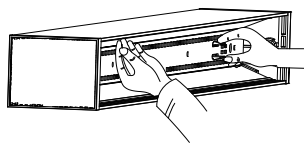
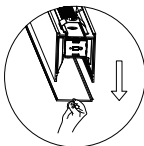
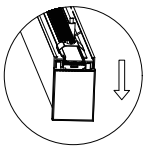
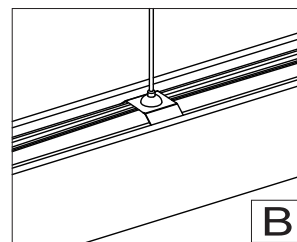
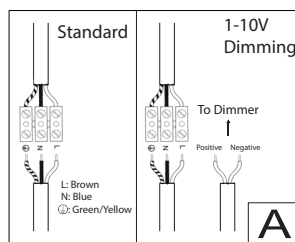
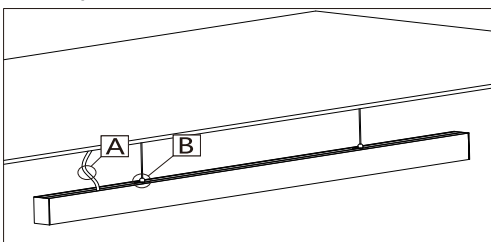

Please Note:

- * Turn off and isolate the electrical supply before connecting this fitting to the building wires.
- * Must be installed, or connected by licenced electrician.
- * The Luminaires are intended for indoor use only.

Applications :

- Hospitality applications
- Residential applications
- Office Buildings
- Hotels
- Shopping Malls
- Supermarkets